

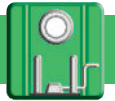

RD/2C-10

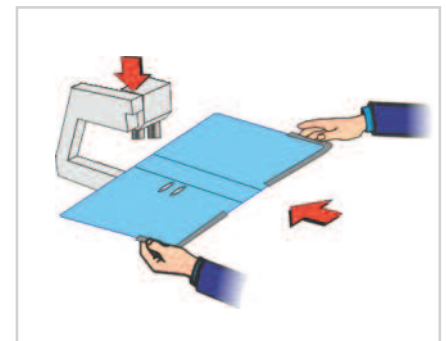

- 🇮🇹 Macchina manuale a motore per l'applicazione di 2 occhielli rado – Posizionamento manuale della plancia – Alimentazione degli occhielli da vibratore
- 🇬🇧 *Motor driven manual machine to apply 2 rado eyelets – Board feeding by hand – Eyelet feeding via vibrator*
- 🇫🇷 Machine manuelle à moteur à poser 2 œillets rado – Positionnement du plat en carton à la main – Alimentation des œillets par vibreur
- 🇨🇳 电机驱动的手控机器，用于打穿两个大孔眼 - 手动放置纸板 - 拥有预打孔与纸板定位功能 - 振动器孔眼进料



- Used materials: Rado eyelets as per your samples
- Board thickness : 1 up to 2,5mm
- Capacity: 500 pcs/hour
- Tension: 220 V – single phase
- Weight: 280 Kg.
- Overall dimensions: L= 1080mm; W= 620mm; H= 1550mm

* Production capacity of every machine depends on sizes, type of materials, glues and operator skill. Peroni's policy is one of continual product improvement and we can reserve the right to alter design and/or specifications without notice